

主要参数 MAIN CHARACTERISTICS

$I_{F(AV)}$	60 A
V_{RRM}	600 V
V_F -typ (@ $I_F=30A$)	1.25 V
T_J	150 °C

用途 APPLICATIONS

高频、高压、大电流整流二极管	High frequency, high voltage, high current rectifier diode
续流二极管	Freewheeling diode
高频开关电源	High frequency switch power supply
极性保护电路	Polarity protection application

产品特性 FEATURES

低功耗	Low power loss
高抗浪涌电流能力	Improved surge current capability
RoHS 产品	RoHS product
低正向导通电压	Low Forward Voltage Drop

封装形式 Package

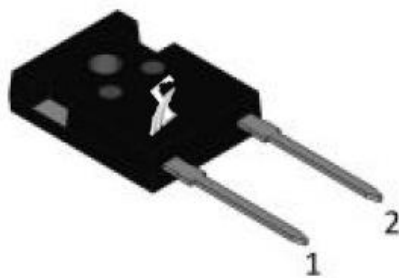

TO-247-2L
FHA series

等效电路 Equivalent Circuit

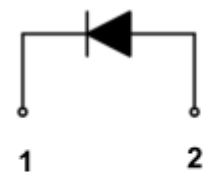

Pin 1 : Cathode

Pin 2 : Anode

绝对最大额定值 ABSOLUTE RATINGS ($T_c=25^\circ C$)

项 目 Parameter	符 号 Symbol	数 值 Value	单 位 Unit
最大反向重复峰值电压 Repetitive peak reverse voltage	V_{RRM}	600	V
正向平均整流电流 Average forward current	$I_{F(AV)}$	60	A
正向峰值浪涌电流 Surge non repetitive forward current (额定负载 8.3ms 半正弦波—按 JEDEC 方法) 8.3 ms single half-sine-wave (JEDEC Method)	I_{FSM}	250	A
耗散功率 Power Dissipation	P_D ($T_C=25^\circ C$)	160	W
	-Derate above 25°C	1.28	W/°C
最高结温 Maximum junction temperature	T_J	150	°C
储存温度 Storage temperature range	T_{STG}	-55~+150	°C

热特性 THERMAL CHARACTERISTIC

项 目 Parameter	符 号 Symbol	最大值 Value (max)	单 位 Unit
结到管壳的热阻 Thermal resistance from junction to case	$R_{th(j-c)}$	0.78	°C/W
结到环境的热阻 Thermal Resistance, Junction to Ambient	$R_{th(j-A)}$	40	°C/W

电特性 ELECTRICAL CHARACTERISTICS

项 目 Parameter	测试条件 Tests conditions		最小值 Value (min)	典型值 Value (typ)	最大值 Value (max)	单位 Unit
IR	Ta =25℃	VR=VRRM	-	-	1	μA
	Ta =125℃		-	-	50	μA
VF	Ta =25℃	IF=10A	-	1.04	1.2	V
	Ta =125℃		-	0.94	1.1	V
VF	Ta =25℃	IF=30A	-	1.25	1.4	V
	Ta =125℃		-	1.15	1.3	V
trr	IF=0.5A, IR=1.0A,Irr=0.25A			50	55	ns

特性曲线

(ELECTRICAL CHARACTERISTICS (curves))

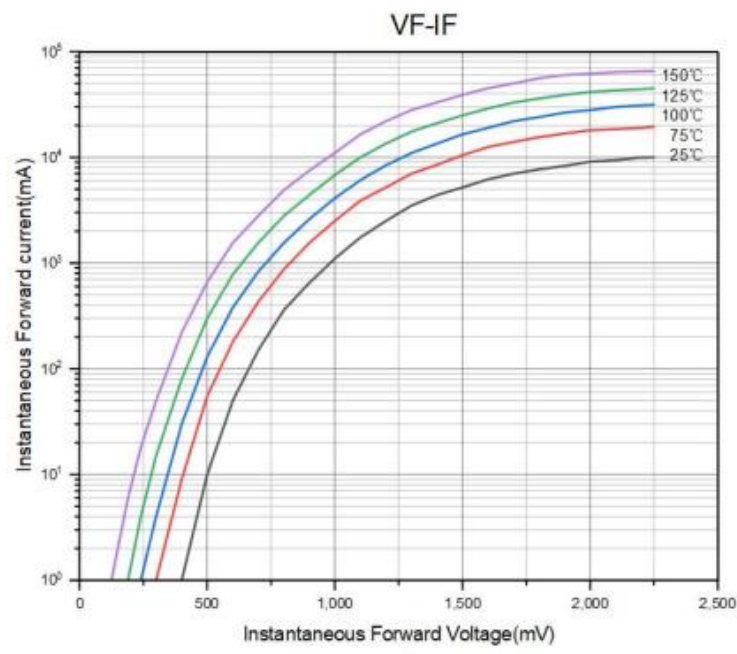

VF-IF

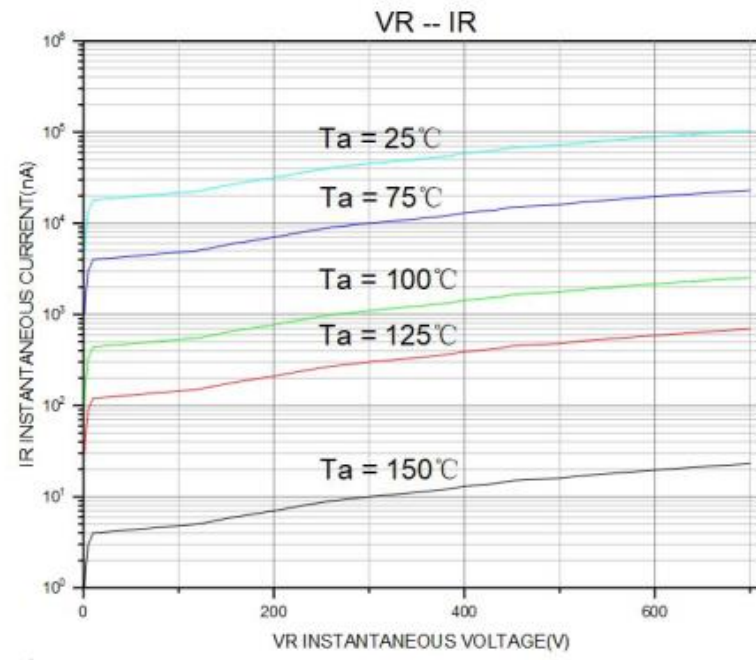

VR-IR

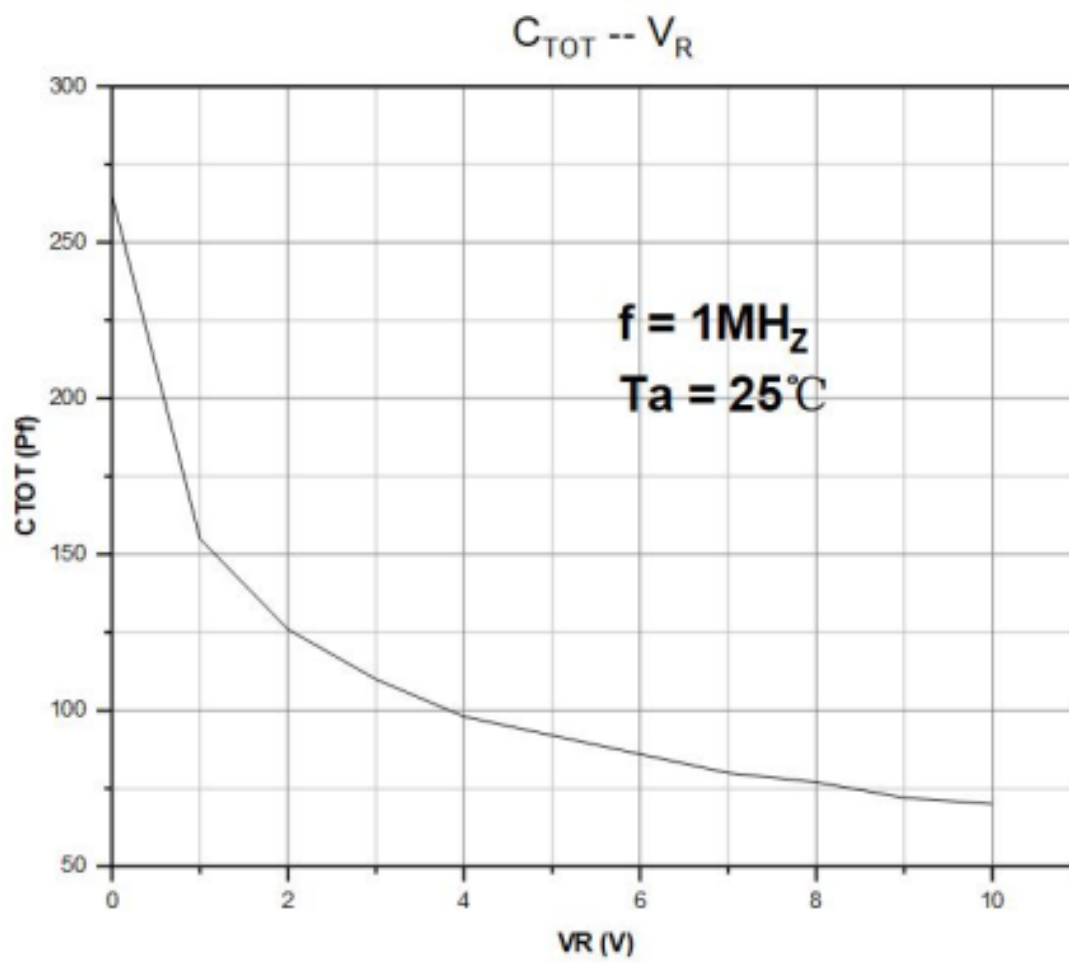

印记 Marking:

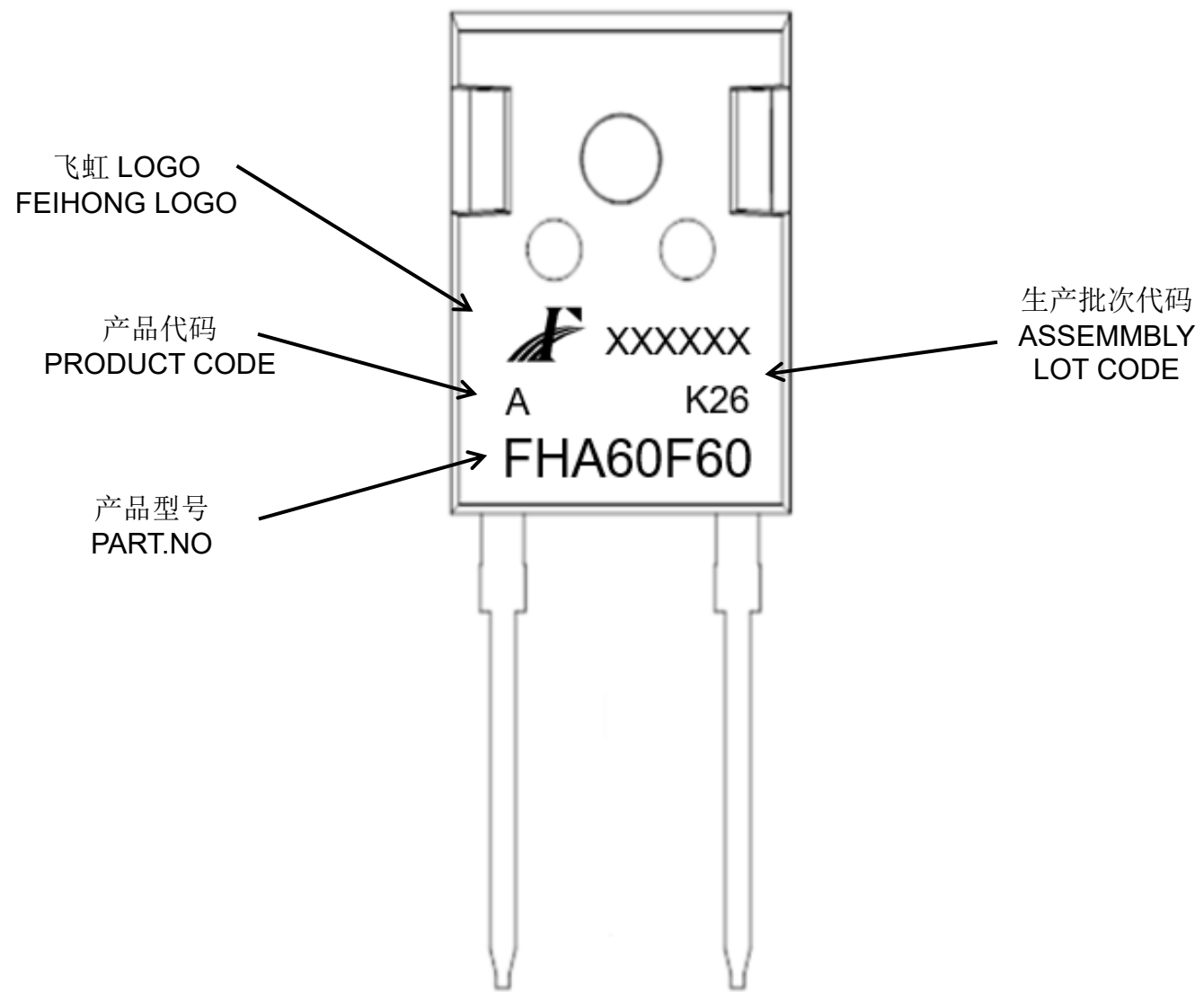

外形尺寸:

Package Dimension:

TO-247-2L

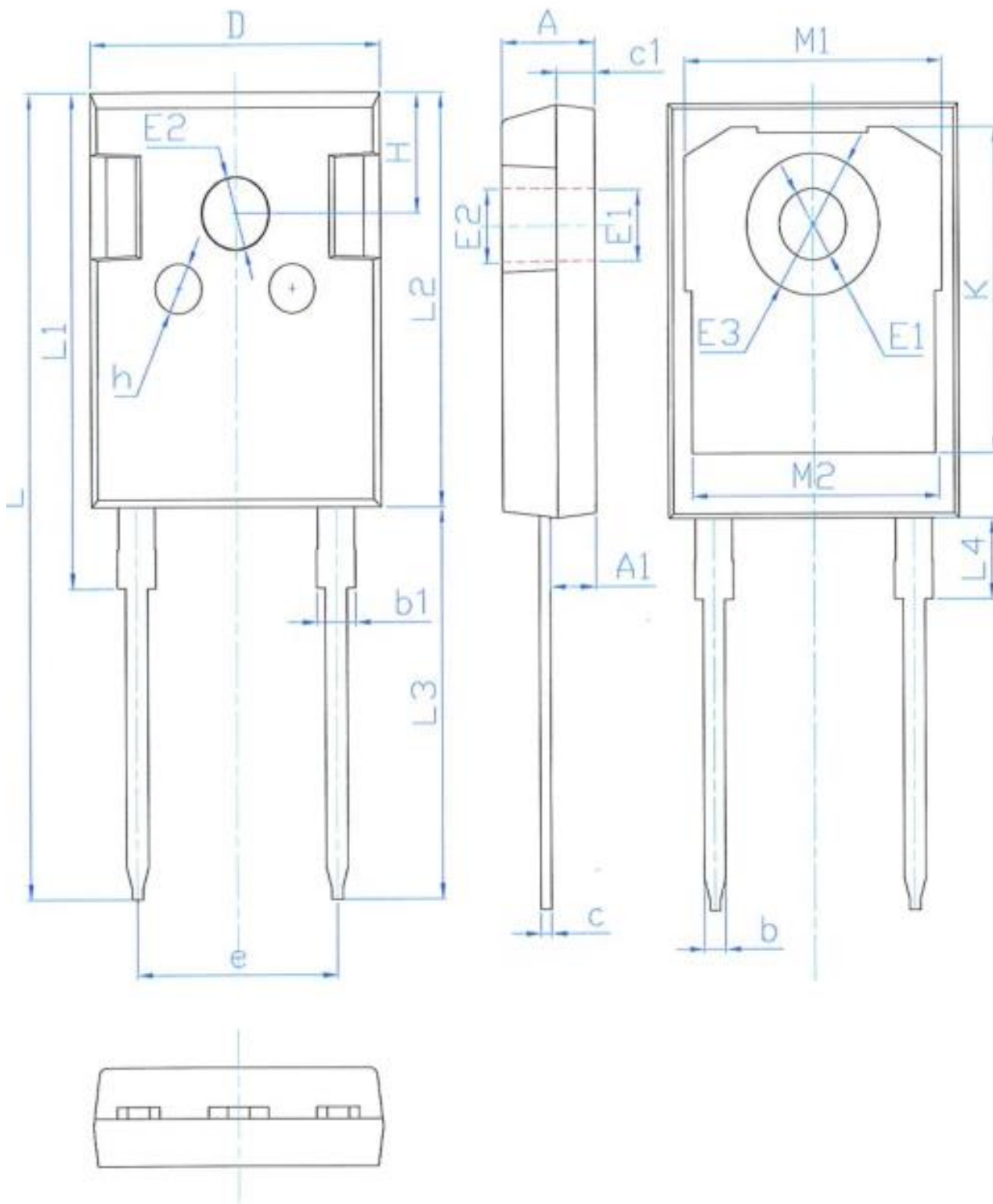

标注	尺寸(mm)
A	5.00±0.20
A1	2.41±0.15
b	1.2±0.10
b1	2.10±0.10
c	0.60±0.10
c1	2.00±0.15
D	15.80±0.20
E1	3.60±0.15
E2	3.70±0.15
E3	7.19±0.15
L	40.92±0.25
L1	24.95±0.15
L2	21.00±0.20
L3	19.92±0.20
L4	4.10±0.15
e	10.87±0.15
H	6.15±0.15
h	2.50±0.15
K	16.45±0.20
M1	14.00±0.20
M2	13.30±0.20